



EZCLONE®



SCAN FOR MORE INFO & INSTRUCTIONS

CLONING MANUAL

A S S E M B L Y & C L O N I N G

ATTENTION - Before initiating Step 1: It is important to flush your manifold of any manufacturing debris that could clog sprayers. Do this by assembling the manifold, without the misters installed, onto the pump with the provided adapter. Place the manifold and pump assembly in a bucket of water below the water level, and turn the pump on. This will pressurize the manifold and clear debris. Proceed to Step 1.

1 Install misters into manifold. Attach manifold to pump using the provided adapter. Place the pump in the center of the reservoir and suction feet securely in place. **TIP: Do not overtighten misters.**

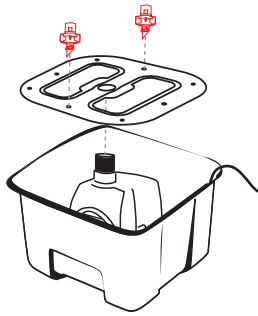

2 Insert cloning collars and fill system with water.

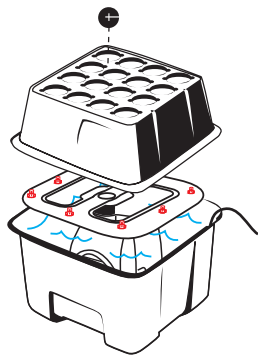

3 Treat your water with the appropriate amount of Clear Rez (1oz./5gal). Start with a nutrient PPM range of 180-280ppm (500 Scale), and a pH balance of 5.8, adjusting back daily. **See PRO TIP on Step 6.**

4 Guide power cord through the molded cord outlet. Make sure the lid is properly seated onto the reservoir to ensure a leak proof seal. Turn pump on by plugging into grounded power source.

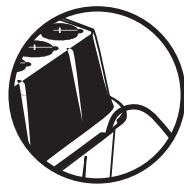

5 Check each cloning collar for adequate irrigation coverage by inspecting for water droplets at the base of each collar.

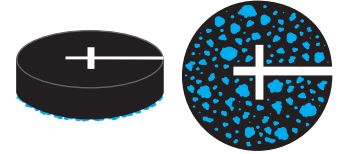

6 Take a 5-6 in. cutting with a sterile blade, dip the cutting into EZ-Clone Rooting Compound, then place into cloning collar while system is turned on.

TIP: If dipping your cutting into the EZ-CLONE Rooting Compound, always pour the Rooting Compound into a separate container for dipping to prevent the cross contamination of your remaining gel.



PRO TIP: For greater consistency in hormone value, instead of dipping your cutting into the Rooting Compound, add 2mL /Gal. of EZ-CLONE Rooting Compound into your water and mix at the end of STEP 3.



RECOMMENDED GUIDE

pH	5.8 (adjust as needed)
PPM	180-280 (500 Scale)
Ambient Temperature	70°-75°F
Water Temperature	69°-75°F
Water Type	75% R.O. & 25% tap (or 100% R.O. with added nutrients)

TIP: While 60% - 70% is most optimal, you can still achieve success in aeroponic cloners with as low as 50% relative humidity.

WARNING: DO NOT PLUG IN PUMP UNTIL FULLY SUBMERGED IN WATER – WILL BURN OUT THE MOTOR!

C L E A N I N G

1 Empty system and refill with bleach water solution (48 mL bleach / gal H2O).

2 Run system with bleach solution for 20 min – 1 hour.

3 After running your bleach solution, drain the reservoir, and rinse bleach from all components. Using soap, thoroughly scrub the system to remove any film or debris. Use fresh water to wash away any particles.

4 Disassemble pump/irrigation manifold assembly and clean all pump components including impeller guard, impeller housing, impeller and face plate as well as removing the back plate of the pump, and rake the inside of the back cavity with a cleaning brush. Rake any remaining inlets, adapters and reservoir drain port with a cleaning brush.

5 Remove and individually inspect each mister to ensure there are no clogs. **TIP: Using a paper clip works well to remove clogs. Also, keeping two sets of misters allows you to soak one set, while quickly replacing the manifold with an already clean set.**

6 Rinse away any remaining soap or bleach residue with freshwater.

7 Dry all components and remove any excess water from the irrigation manifold and pump cavities. Insert new cloning collars and prepare for the next cloning cycle. If preparing for long term storage, dry all components inside and out before storing. Compressed air works well for this.

Please visit EZ-CLONE's YOU TUBE Channel for detailed demonstration videos on cloning processes and cleaning procedures.

<https://www.youtube.com/channel/UCWFxWC6b576A6UE36locEwA>